

Alternative top caps

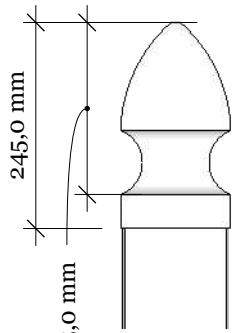

Gothic

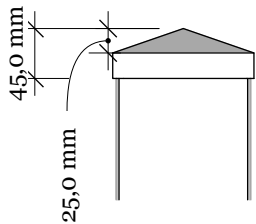

Anonymous

FA-8DG Sønnavind Diagonal Grey 147-105 with New England top

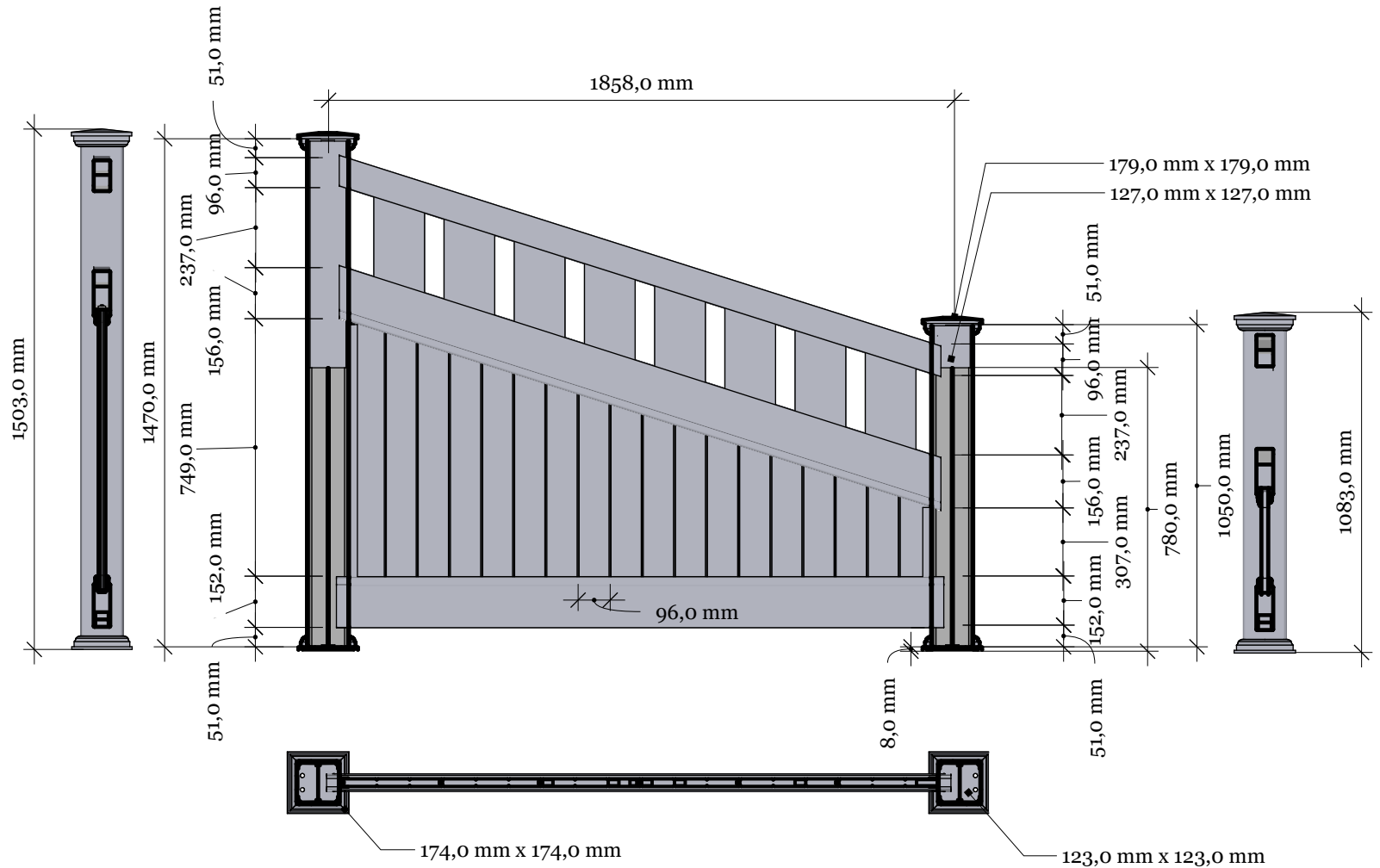

FA-8DG Sønnavind Diagonal Grey 147-105

www.kystgjerdet.com

Revisions		
	MM/DD/YY	Notes
1	14/11/17	Sheet Production - RL
2	06/10/20	Name definition, and layout update - MS
3	10/02/21	Layout update - RL
4	02/02/23	Layout update - LMS
5	--/--/--	...

A 04

FA-8DG Sønnavind Diagonal Grey 147-105 with New England top

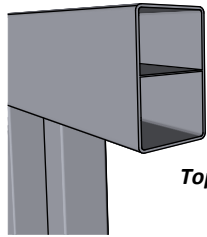

Top rail profile

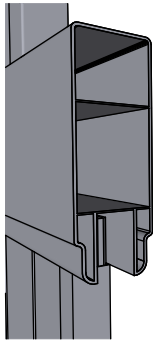

Middle rail profile

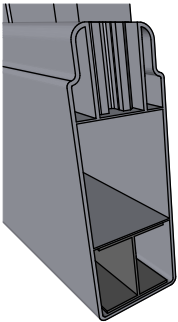

Aluminum profile in bottom rail to prevent deflection

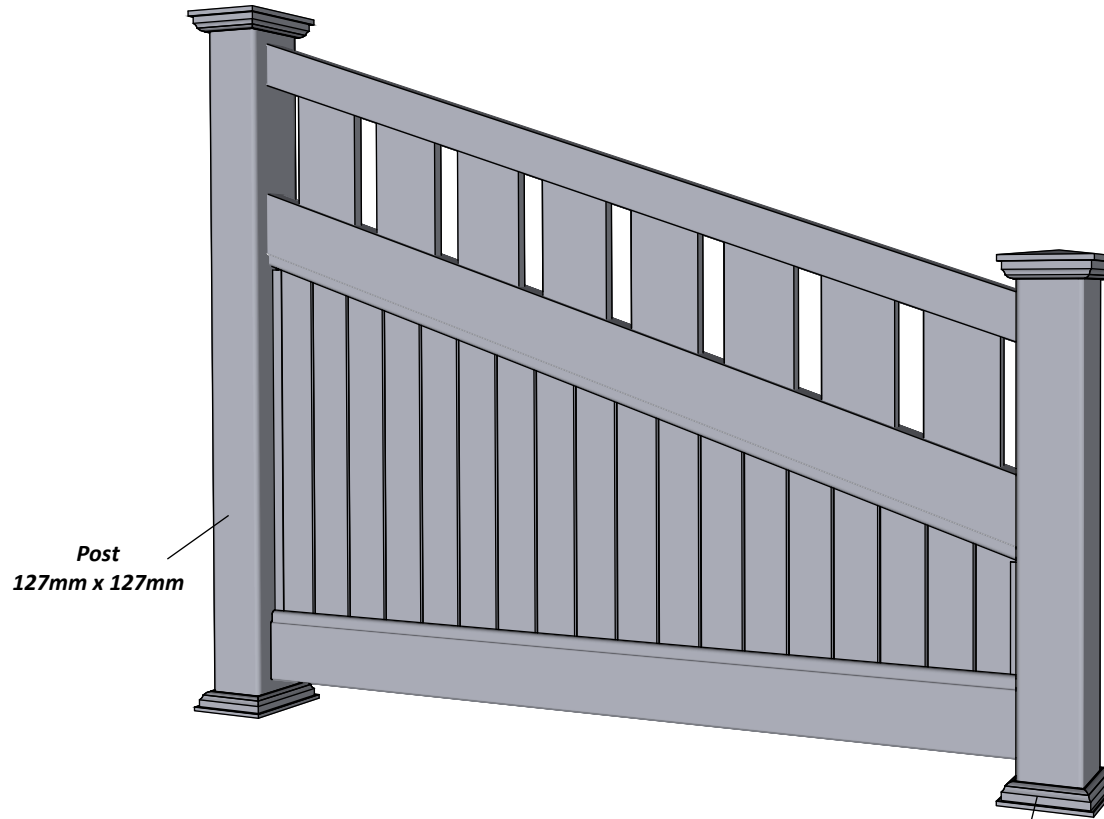

Post
127mm x 127mm

Bottom cover
174mm x 174mm.

Rigid aluminum insert in post

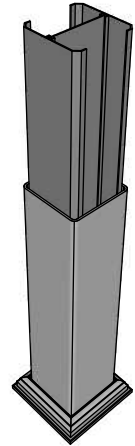

Bottom of insert is
123mm x 123mm
8mm thickness of alu

Dia = 12mm

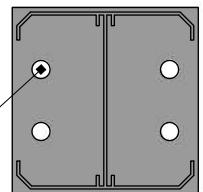

KYSTGJERDET

FA-8DG Sønnavind Diagonal Grey 147-105

www.kystgjerdet.com

Revisions

	MM/DD/YY	Notes
1	14/11/17	Sheet Production - RL
2	06/10/20	Name definition, and layout update - MS
3	10/02/21	Layout update - RL
4	02/03/23	Layout update - LMS
5	--/--/--	...

A 04

A

Alt. for component 1:

Art. No: 102300

Art. No: 102300

Art. No: 102303

Component 2 & 10:

Special Post: Art. No: 101541
For pack no: 4915

Special Post: Art. No: 101518
For pack no: 4915



Component overview for pack no: 4915

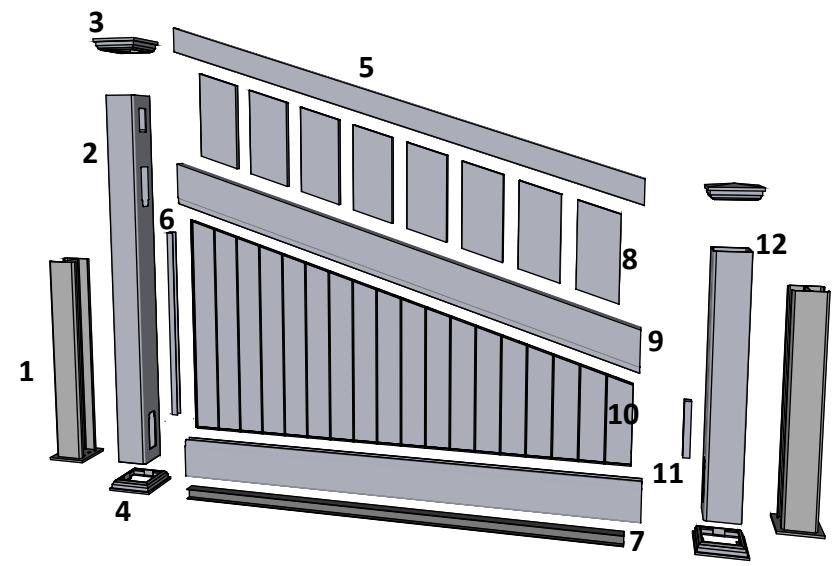

1 full section contains:

1. Aluminum inserts for posts	- Art. No: See alternatives
2. PVC post (tall)	- Art. No: 101541
3. New England top (as standard)	- Art. No: 102465
4. Bottom cover	- Art. No: 102451
5. Top rail	- Art. No: 100280
6. Endlists for panel (tall)	- Art. No: 101887
7. Bottom rail with alu. liner	- Art. No: 100402
8. 8 Pickets	- Art. No: 101738
9. Middle rail	- Art. No: 100561
10. Panel	- Art. No: 102238
11. Endlists for panel (short)	- Art. No: 101886
12. PVC post (short)	- Art. No: 101518

Additional posts can be purchased separately:

Tall Special Post - Pack no: 8842

Short Special Post - Pack no: 8819



FA-8DG Sønnavind Diagonal Grey 147-105

www.kystgjerdet.com

Revisions		
1	14/11/17	Sheet Production - RL
2	06/10/20	Name definition, and layout update - MS
3	10/02/21	Layout update - RL
4	02/03/23	Layout update - LMS
5	--/--/--	...

A 04