

Alternative top caps

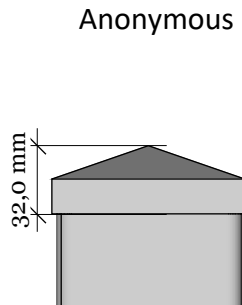

FA-4G Fønvind Grey 147 with New England top

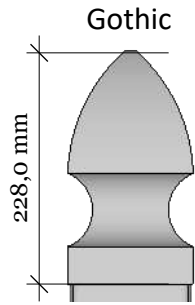
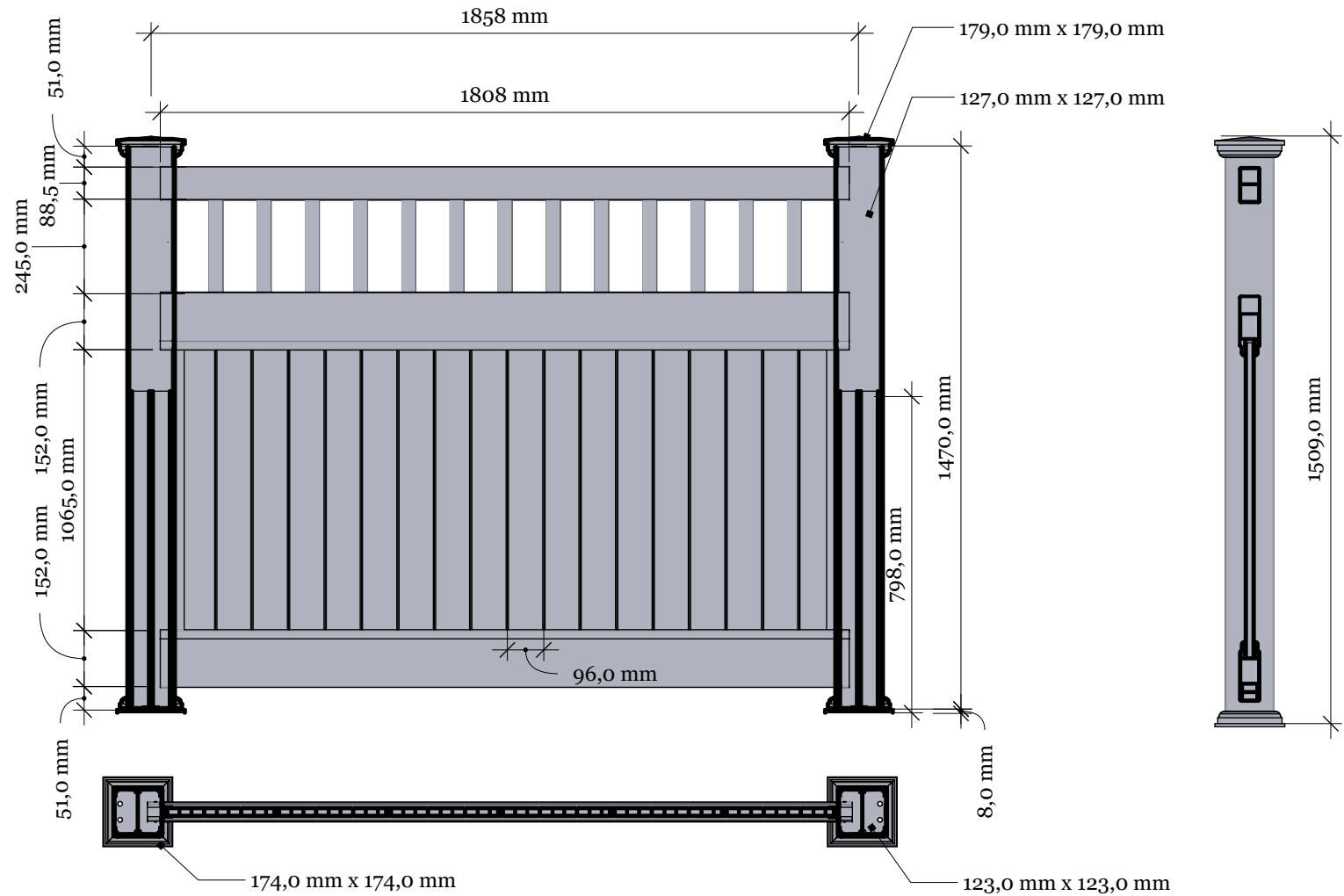

Revisions

	MM/DD/YY	Notes
1	14/11/17	Sheet Production - RL
2	06/10/20	Name definition, and layout update - MS
3	10/02/21	Layout update - RL
4	02/03/23	Layout update - LMS
5	---/---/---	...

FA-4G Fønvind Grey 147 with New England top

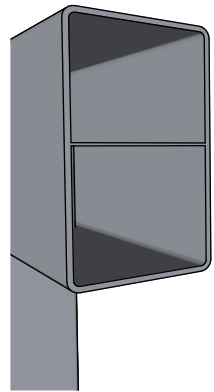

Top rail profile

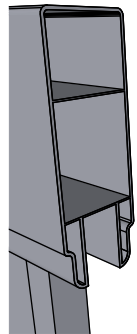

Middle rail profile

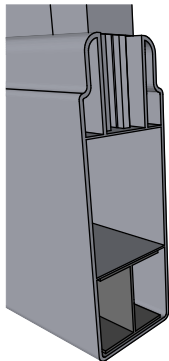

Aluminum profile in bottom rail to prevent deflection

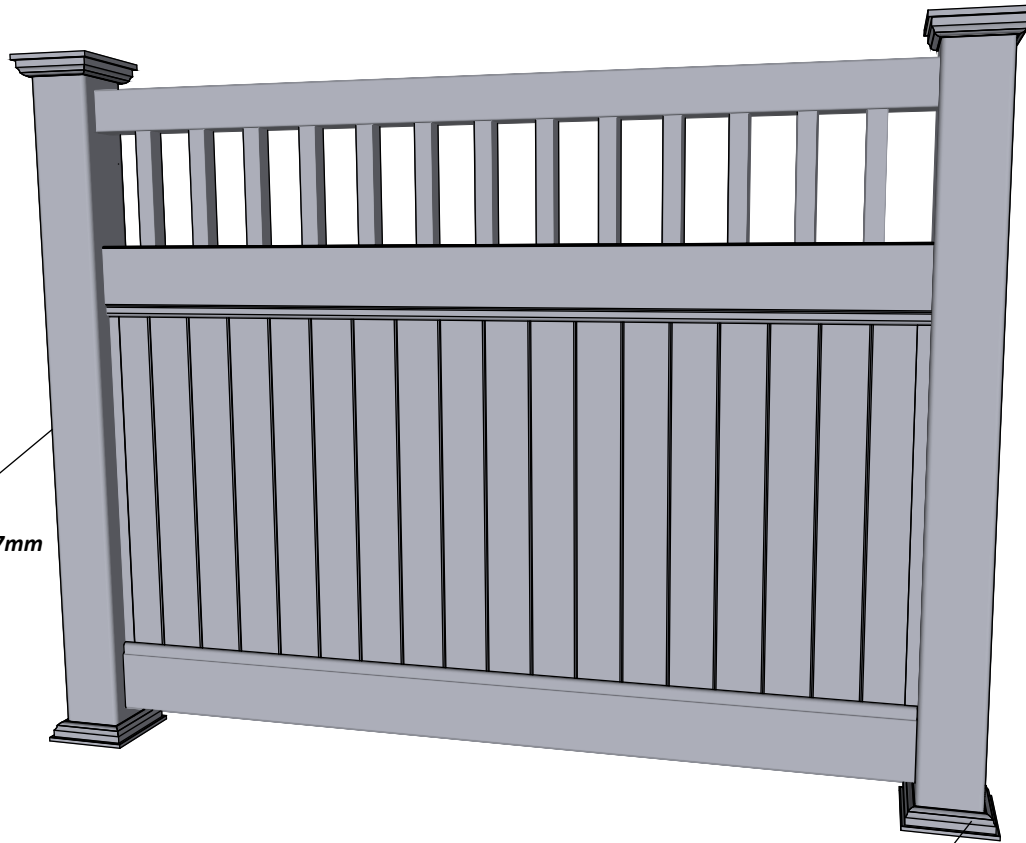

Post
127mm x 127mm

Bottom cover
174mm x 174mm.

Rigid aluminum insert in post

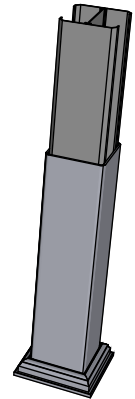

Bottom of insert is
123mm x 123mm
8mm thickness of alu

Dia = 12mm

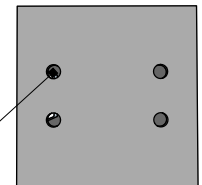

KYSTGJERDET

FA-4G Fønvind Grey 147

www.kystgjerdet.com

Revisions

	MM/DD/YY	Notes
1	14/11/17	Sheet Production - RL
2	06/10/20	Name definition, and layout update - MS
3	10/02/21	Layout update - RL
4	02/02/23	Layout update - LMS
5	--/--/--	...

A 04

A

Alt. for component 1:

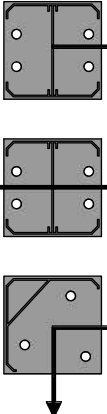

Art. No: 102300

Art. No: 102300

Art. No: 102303

Alt. for component 2:



Line Post: Art. No: 101052
For pack no: 4300

End Post: Art. No: 101053
For pack no: 4301

Corner Post: Art. No: 101054
For pack no: 4302

Special Post: Art. No: 101541
For pack no: 4303

Component overview for pack no: 4300-4303

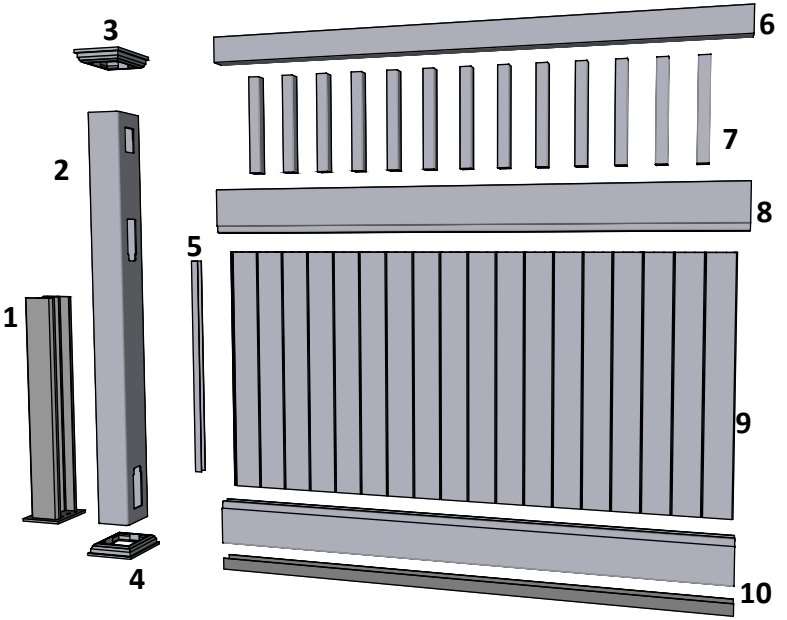

1 full section contains:

1. Aluminum insert for post	- Art. No: See alternatives
2. PVC post	- Art. No: See alternatives
3. New England top (as standard)	- Art. No: 102465
4. Bottom cover	- Art. No: 102451
5. Endlists for panel	- Art. No: 101823
6. Top rail	- Art. No: 100246
7. 13 Pickets	- Art. No: 101681
8. Middle Rail	- Art. No: 100543
9. Panel	- Art. No: 102209
10. Bottom rail with alu. liner	- Art. No: 100402

Additional posts can be purchased separately:

Line Post - Pack no: 8702

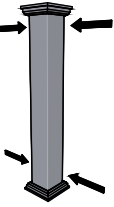

End Post - Pack no: 8703

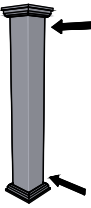

Corner Post - Pack no: 8704

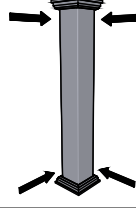

Special Post - Pack no: 8842

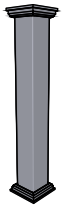

Revisions		
1	14/11/17	Sheet Production - RL
2	06/10/20	Name definition, and layout update - MS
3	10/02/21	Layout update - RL
4	02/02/23	Layout update - LMS
5	---/---/---	...